

STEP 180 LITE - SPECIFICATIONS

SIDE VIEW - Extended Closed Position

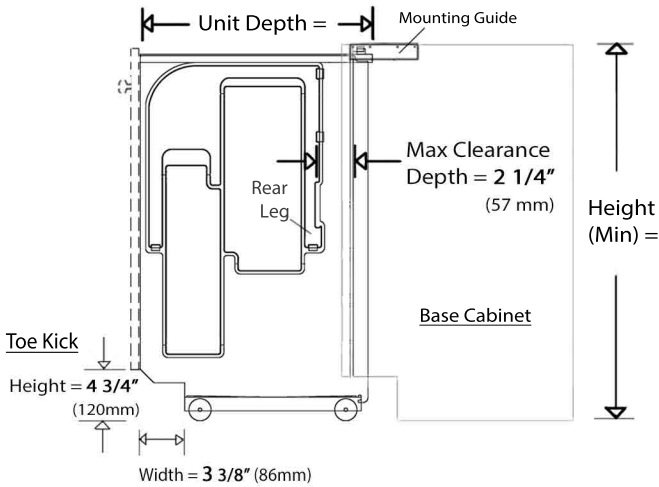

FRONT VIEW - Extended And Deployed Positions

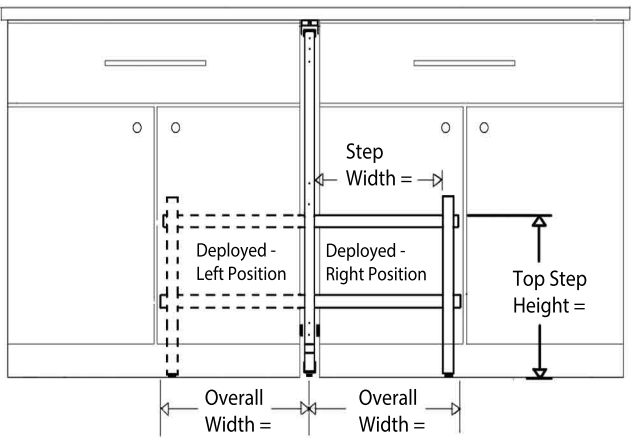

TOP VIEW - Mounted Between Base Cabinet & 2nd Base Cabinet

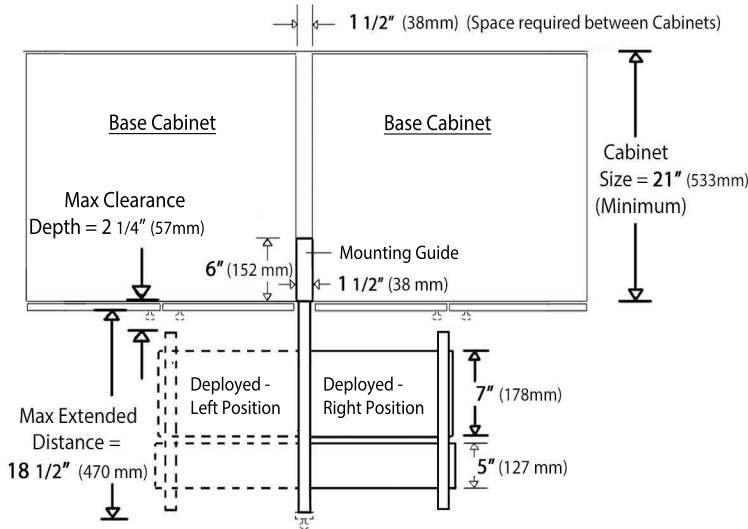

TOP VIEW - Mounted Between Base Cabinet & End Panel

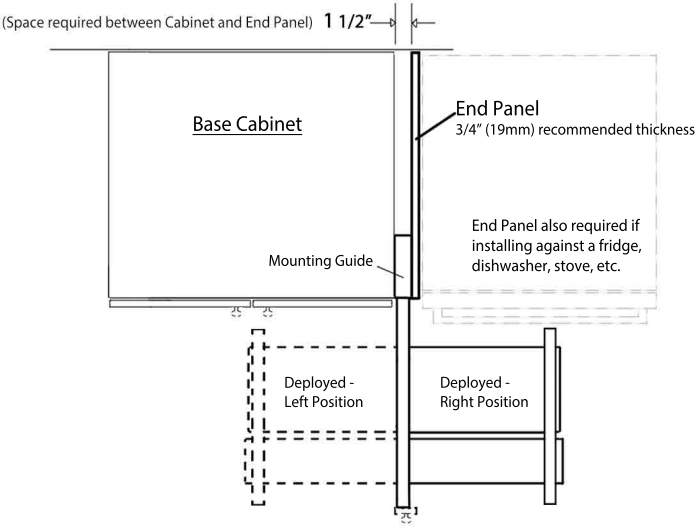

STEP 180 LITE

Cabinet Size (Depth)  
(Generally Designed For):

Cabinet Space requirements:

Width (between cabinets) \_\_\_\_\_  
Height (Minimum) \_\_\_\_\_  
Unit Depth \_\_\_\_\_

Step Units Deployed Clearances:

Max Clearance Depth (From Cabinet Frame)  
Max Extended Distance (From Cabinet Frame)  
Overall Width (From Center Of Unit)

Step Dimensions:

Step Width (Usable) \_\_\_\_\_  
Top Step Depth \_\_\_\_\_  
Top Step Height \_\_\_\_\_

Toe Kick (Height  
x Depth)

Weight (Step Unit) \_\_\_\_\_  
Weight Limit (Duty Rating) \_\_\_\_\_  
Country of Origin \_\_\_\_\_

34" (860 mm) tall models

	21" (533mm) (US Bath & Intl Kitchens)
	1 1/2" (38 mm)
33 7/8" (860 mm)	or (34 1/2" (876 mm) w/ Touch-to-Open option) 20 7/8" (530 mm)
	2 1/4" (57 mm)
	18 1/2" (470 mm)
	16 " (406 mm)
	14 1/4" (362 mm)
	7" (178 mm)
	14 1/2" (368 mm)
	4 3/4" (120 mm)
	x 3 3/8" (86 mm)
	16 lbs (7.3 kg)
	200 lbs (90.7 kg)

32" (813 mm) tall models

	21" (533mm) (US Bath & Intl Kitchens)
	1 1/2" (38 mm)
32"(813 mm)	or (32 5/8"(828 mm) w/ Touch-to-Open) 20 7/8" (530 mm)
	2 1/4" (57 mm)
	18 1/2" (470 mm)
	15" (381 mm)
	13 1/4" (337 mm)
	7" (178 mm)
	13 3/4" (349 mm)
	4 3/4" (120 mm)
	x 3 3/8" (86 mm)
	15 lbs (6.8 kg)
	200 lbs (90.7 kg)

Designed and Manufactured in the USA

Does Not Include Toe Kick, Face Panel, Pull Handle Or Cabinets